

ASA25B-1-2 | Sprockets



Z	d _e	d _p	SIMPLEX							
			D _m	D ₁	A					
8	19.4	16.58	10	6	12					
9	21.4	18.56	11.5	6	12					
10	23.3	20.55	13	6	12					
11	25.3	22.54	15	8	13					
12	27.3	24.53	17	8	13					
13	29.3	26.53	17	8	13					
14	31.3	28.53	17	8	13					
15	33.3	30.53	20	8	13					
16	35.3	32.55	22	8	14					
17	37.3	34.55	22	8	14					
18	39.4	36.56	25	8	14					
19	41.4	38.58	25	8	14					
20	43.4	40.58	25	8	14					
21	45.4	42.60	30	8	14					
22	47.4	44.62	30	8	14					
23	49.4	46.63	30	8	14					
24	51.4	48.64	30	8	14					
25	53.5	50.66	30	8	14					
26	55.5	52.67	30	8	14					
27	57.5	54.69	30	8	16					
28	59.5	56.71	30	8	16					
29	61.5	58.73	30	8	16					
30	63.6	60.75	30	8	16					
31	65.6	62.76	30	8	16					
32	67.6	64.78	30	8	16					
33	69.6	66.80	30	8	16					
34	71.6	68.82	30	8	16					
35	73.6	70.84	30	8	16					
36	75.6	72.85	30	8	16					
37	77.7	74.87	30	8	16					
38	79.7	76.89	30	8	16					
39	81.7	78.91	30	8	16					
40	83.7	80.93	30	8	16					
41	85.7	82.95	40	10	18					
42	87.8	84.97	40	10	18					
43	89.8	86.98	40	10	18					
44	91.8	89.01	40	10	18					
45	93.8	91.03	40	10	18					
46	95.8	93.05	40	10	18					
47	97.9	95.07	40	10	18					
48	99.9	97.09	40	10	18					
49	101.9	99.10	40	10	18					
50	103.9	101.13	40	10	18					
51	105.9	103.14	40	10	18					
52	108.0	105.16	40	10	18					
53	110.0	107.18	40	10	18					
54	112.0	109.18	40	10	18					
55	114.0	111.23	40	10	18					
56	116.0	113.25	40	10	18					
57	118.1	115.27	40	10	18					
58	120.1	117.29	50	10	20					
59	122.1	119.31	50	10	20					
60	124.1	121.32	50	10	20					
62	128.2	125.37	50	10	20					
64	132.2	129.41	50	10	20					
65	134.2	131.43	50	10	20					
66	136.2	133.45	50	10	20					
68	140.3	137.49	50	10	20					
70	144.3	141.53	50	10	20					
72	148.4	145.58	50	10	20					
75	154.4	151.63	50	10	20					
76	156.5	153.66	50	10	20					
78	160.5	157.70	70	10	30					
80	164.5	161.74	70	10	30					
85	174.6	171.85	70	10	30					
90	184.7	181.95	70	10	30					
95	194.8	192.05	70	10	30					
100	204.9	202.15	70	10	30					
110	225.1	222.37	70	10	30					
114	233.2	230.45	70	10	30					
120	245.4	242.58	70	10	30					
125	255.5	252.68	70	10	30					

SPROCKETS 1/4" X1/8"

For chain Acc. to DIN 8187
ISO/R 606

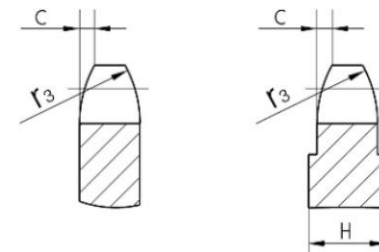
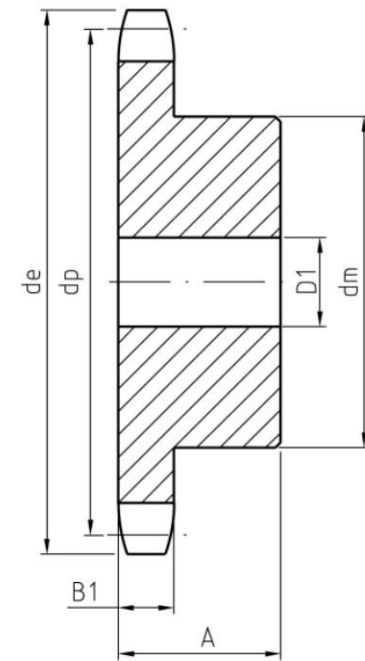

SPROCKETS mm

Tooth radius r ₃	6.4
Radius width C	0.7
Tooth width B ₁	2.9

CHAIN mm

Pitch	6.35
Internal width	3.18
Roller Φ	3.3

H=4mm, From Z=62 the width of the plate is increased

Sprockets

ASA25A-1-2 | Platewheels



Platewheels

Z	d _e	d _p	S
			D ₁
8	19.4	16.58	6
9	21.4	18.56	6
10	23.3	20.55	6
11	25.3	22.54	8
12	27.3	24.53	8
13	29.3	26.53	8
14	31.3	28.53	8
15	33.3	30.53	8
16	35.3	32.55	8
17	37.3	34.55	8
18	39.4	36.56	8
19	41.4	38.58	8
20	43.4	40.58	8
21	45.4	42.60	8
22	47.4	44.62	8
23	49.4	46.63	8
24	51.4	48.64	8
25	53.5	50.66	8
26	55.5	52.67	8
27	57.5	54.69	8
28	59.5	56.71	8
29	61.5	58.73	8
30	63.6	60.75	8
31	65.6	62.76	10
32	67.6	64.78	10
33	69.6	66.80	10
34	71.6	68.82	10
35	73.6	70.84	10
36	75.6	72.85	10
37	77.7	74.87	10
38	79.7	76.89	10
39	81.7	78.91	10
40	83.7	80.93	10
41	85.7	82.95	10
42	87.8	84.97	10
43	89.8	86.98	10
44	91.8	89.01	10
45	93.8	91.03	10
46	95.8	93.05	10
47	97.9	95.07	10
48	99.9	97.09	10
49	101.9	99.10	10
50	103.9	101.13	10
51	105.9	103.14	12
52	108.0	105.16	12
53	110.0	107.18	12
54	112.0	109.18	12
55	114.0	111.23	12
56	116.0	113.25	12
57	118.1	115.27	12
58	120.1	117.29	12
59	122.1	119.31	12
60	124.1	121.32	12
62	128.2	125.37	12
64	132.2	129.41	12
65	134.2	131.43	12
66	136.2	133.45	14
68	140.3	137.49	14
70	144.3	141.53	14
72	148.4	145.58	14
75	154.4	151.63	14
76	156.5	153.66	14
78	160.5	157.70	16
80	164.5	161.74	16
85	174.6	171.85	16
90	184.7	181.95	16
95	194.8	192.05	16
100	204.9	202.15	16
110	225.1	222.37	16
114	233.2	230.45	16
120	245.4	242.58	16
125	255.5	252.68	16

PLATEWHEELS 1/4" X 1/8"

For chain Acc. to DIN 8187
ISO/R 606

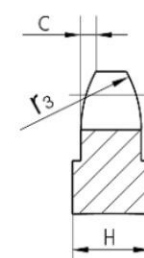
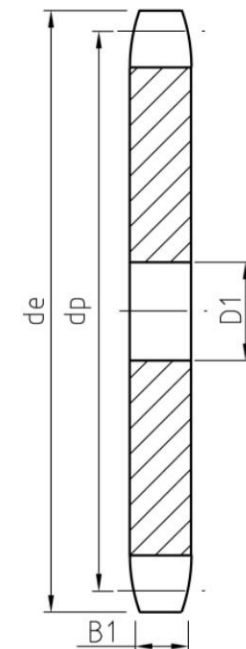

PLATEWHEELS mm

Tooth radius r ₃	6.4
Radius width C	0.7
Tooth width B ₁	2.9

CHAIN mm

Pitch	6.35
Internal width	3.18
Roller Φ	3.3

H=4mm, From Z=51 the width of the plate is increased

ASA35/40 | ASA Sprockets & Platewheels



PITCH 3/8" X3/16

For Chain
Acc. to DIN 8188 **ASA 35**
ISO/R 606

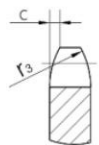

SPROCKETS & PLATEWHEELS

	mm
Tooth radius r_3	10
Radius width C	1.2
Tooth width B_1	4.4
Tooth width b_1	4.3
Tooth width B_2	14.4
Tooth width B_2	24.5

CHAIN

	mm
Pitch	9.525
Internal width	4.77
Roller Φ	5.08
Material: C45	

SPROCKETS			SIMPLEX			DUPLEX		
Z	d_e	d_p	d_m	D_2	A	d_m	D_3	A
10	35.70	30.82	20	8	20			
11	38.69	33.80	22	8	25			
12	41.68	36.80	25	8	25			
13	44.68	39.80	28	8	25	28	10	25
14	47.68	42.80	31	8	25	31	10	25
15	50.69	45.81	34	8	25	34	10	25
16	53.70	48.82	37	10	28	37	12	30
17	56.72	51.83	38	10	28	40	12	30
18	59.73	54.85	38	10	28	43	12	30
19	62.75	57.87	45	10	28	46	12	30
20	65.77	60.89	46	10	28	49	12	30
21	68.79	63.91	46	10	28	52	12	30
22	71.81	66.93	50	12	28	55	12	30
23	74.83	69.95	52	12	28	58	12	30
24	77.85	72.97	52	12	28	61	12	30
25	80.88	76.00	57	12	28	64	12	30
26	83.90	79.02	58	12	28	67	12	30
27	86.93	82.04	58	12	28	70	12	30
28	89.95	85.07	60	12	28	73	12	30
30	96.00	91.12	60	12	28			
PLATEWHEELS			S	D	T			
Z	d_e	d_p	D_1	D_2	D_3			
30	96.00	91.12		12				
32	102.06	97.17	12					
36	114.17	109.29	12					
38	120.22	115.34	12	14				
40	126.28	121.40	12					
45	141.43	136.55	16	16				
48	150.52	145.64	16					
57	177.79	172.91	16	16				
76	235.37	230.49	20	20				

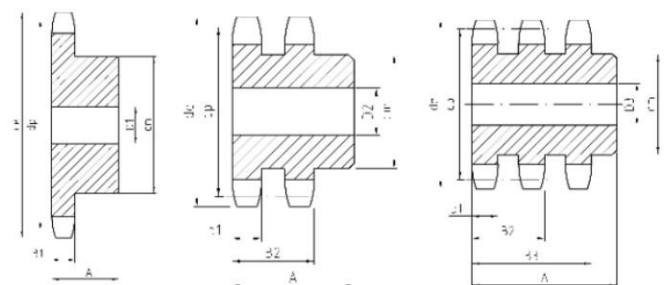

SPROCKETS			SIMPLEX			DUPLEX			TRIPLEX		
Z	d_e	d_p	d_m	D_1	A	d_m	D_2	A	d_m	D_3	A
10	47.66	41.10	26	10	25						
11	51.64	45.08	29	10	25						
12	55.63	49.07	33	10	28				35	14	50
13	59.63	53.07	35	10	28	38	12	35	38	14	50
14	63.63	57.07	41	10	28	42	12	35	42	14	50
15	67.64	61.08	45	10	28	46	12	35	46	14	50
16	71.66	65.10	48	10	28	50	14	35	50	16	50
17	75.68	69.12	48	10	28	54	14	35	54	16	50
18	79.70	73.14	56	12	28	58	14	35	58	16	50
19	83.72	77.16	60	12	28	62	14	35	62	16	50
20	87.74	81.18	60	12	28	66	14	35	66	16	50
21	91.77	85.21	65	12	28	70	16	40	70	20	55
22	95.80	89.24	65	12	28	70	16	40	70	20	55
23	99.83	93.27	65	12	28	70	16	40	70	20	55
24	103.86	97.30	70	14	28	75	16	40	75	20	55
25	107.89	101.33	70	14	28	80	16	40	80	20	55
26	111.92	105.36	70	14	28	85	16	40	85	20	55
27	115.96	109.40	70	16	30	85	16	40	85	20	55
28	119.99	113.43	70	16	30	90	16	40	90	20	55
30	128.06	121.50	80	16	30	100	16	40	90	20	55
32	136.13	129.57	80	16	30						
35	148.24	141.68	90	16	30						
36	152.28	145.72	90	16	30						
38	160.35	153.79	90	16	35						
40	168.43	161.87	90	16	35						
PLATEWHEELS			S	D	T						
Z	d_e	d_p	D_1	D_2	D_3						
30	128.06	121.50			20						
32	136.13	129.57		16							
38	160.35	153.79		20	25						
40	168.43	161.87		20							
42	176.50	169.94	20								
45	188.62	182.06	20	20	25						
48	200.74	194.18	20								
57	237.10	230.54	20	25	25						
76	313.88	307.32	25	25	25						
95	390.67	384.11		25							

PITCH 1/2" X5/16

For Chain
Acc. to DIN 8188 **ASA 40**
ISO/R 606

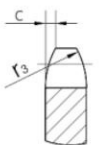

SPROCKETS & PLATEWHEELS

	mm
Tooth radius r_3	13.5
Radius width C	1.6
Tooth width B_1	7.4
Tooth width b_1	7.2
Tooth width B_2	21.6
Tooth width B_3	36

CHAIN

	mm
Pitch	12.7
Internal width	7.94
Roller Φ	7.94
Material: C45	

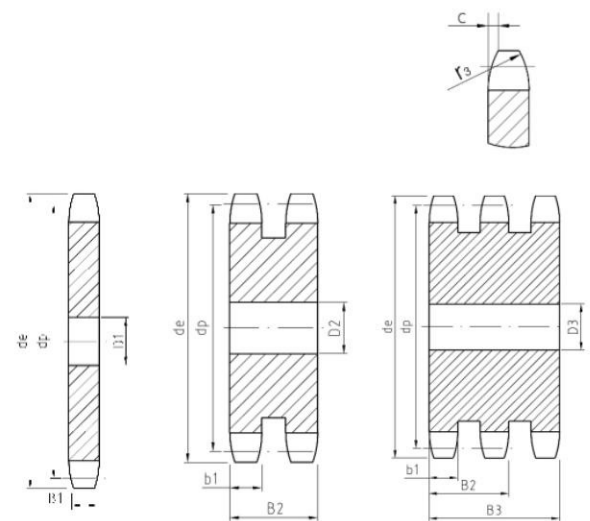

ASA50 | ASA Sprockets & Platewheels



Sprockets
Platewheels

SPROCKETS			SIMPLEX			DUPLEX			TRIPLEX		
Z	d _e	d _p	d _m	D ₁	A	d _m	D ₂	A	d _m	D ₃	A
8	47.0	41.48	25	10	25						
9	52.6	46.42	30	10	25						
10	57.5	51.37	35	10	25						
11	63.0	56.34	37	12	30						
12	68.0	61.34	42	12	30				44	16	55
13	73.0	66.32	47	12	30	49	14	40	49	16	55
14	78.0	71.34	52	12	30	54	14	40	54	16	55
15	83.0	76.36	57	12	30	59	14	40	59	16	55
16	88.0	81.37	60	12	30	64	16	45	64	16	60
17	93.0	86.39	60	12	30	69	16	45	69	16	60
18	98.3	91.42	70	14	30	74	16	45	74	16	60
19	103.3	96.45	70	14	30	79	16	45	79	16	60
20	108.4	101.49	75	14	30	84	16	45	84	16	60
21	113.4	106.52	75	16	30	85	16	45	85	20	60
22	118.0	111.55	80	16	30	90	16	45	90	20	60
23	123.4	116.58	80	16	30	95	16	45	95	20	60
24	128.3	121.62	80	16	30	100	16	45	100	20	60
25	134.0	126.66	80	16	30	105	16	45	105	20	60
26	139.0	131.70	85	20	35				110	20	60
27	144.0	136.75	85	20	35				110	20	60
28	148.7	141.78	90	20	35				115	20	60
29	153.8	146.83	90	20	35						
30	158.8	151.87	90	20	35						
31	163.9	156.92	95	20	35						
32	168.9	161.95	95	20	35						
33	174.5	167.00	95	20	35						
34	179.0	172.05	95	20	35						
35	184.1	177.10	95	20	35						
36	189.1	182.15	100	20	35						
37	194.2	187.20	100	20	35						
38	199.2	192.24	100	20	35						
39	204.2	197.29	100	20	35						
40	209.3	202.34	100	20	35						

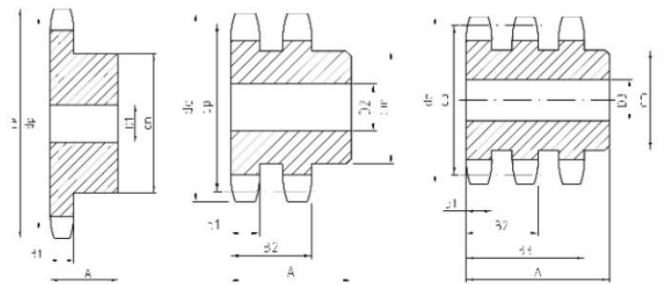

PITCH 5/8" X3/8"

For Chain
Acc. to DIN 8188 **ASA 50**
ISO/R 606

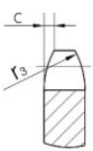

SPROCKETS mm

Tooth radius r ₃	17
Radius width C	2
Tooth width B ₁	9
Tooth width b ₁	8.8
Tooth width B ₂	26.9
Tooth width B ₃	45

CHAIN mm

Pitch	15.875
Internal width	9.52
Roller Φ	10.16
Material: C45	

PLATEWHEELS			S	D	T	Z	d _e	d _p	S	D	T
Z	d _e	d _p	D ₁	D ₂	D ₃				D ₁	D ₂	D ₃
8	47.0	41.48	10			44	230.0	222.53	20		
9	52.6	46.42	10			45	235.0	227.58	20	20	25
10	57.5	51.37	10			46	240.1	232.63	20		
11	63.0	56.34	10			47	245.1	237.68	20		
12	68.0	61.34	10			48	250.2	242.73	20		
13	73.0	66.32	10			49	255.2	247.78	20		
14	78.0	71.34	10			50	260.3	252.82	20		
15	83.0	76.36	10			51	265.3	257.87	20		
16	88.0	81.37	12			52	270.4	262.92	20		
17	93.0	86.38	12			53	275.4	267.97	20		
18	98.3	91.42	12			54	280.5	273.03	20		
19	103.3	96.45	12			55	285.5	278.08	20		
20	108.4	101.49	12			56	290.6	283.13	25		
21	113.4	106.52	12			57	296.0	288.18	25	25	25
22	118.0	111.55	12			58	300.7	293.23	25		
23	123.5	116.58	12			59	305.7	298.27	25		
24	128.3	121.62	12			60	310.8	303.32	25		
25	134.0	126.66	12			62	321.4	313.43	25		
26	139.0	131.70	16			64	331.5	323.53	25		
27	144.0	136.75	16			65	336.5	328.58	25		
28	148.7	141.78	16			66	341.6	333.63	25		
29	153.8	146.83	16			68	351.7	343.74	25		
30	158.8	151.87	16	20	20	70	361.8	353.84	25		
31	163.9	156.92	16			72	371.9	363.95	25		
32	168.9	161.95	16			75	387.1	379.09	25		
33	174.5	167.00	16			76	392.1	384.16	25	25	30
34	179.0	172.05	16			78	402.2	394.25	25		
35	184.1	177.10	16			80	412.3	404.35	25		
36	189.1	182.15	20			85	437.6	429.62	30		
37	194.2	187.20	20			90	462.8	454.88	30		
38	199.2	192.24	20	20	25	95	488.5	480.14	30	30	
39	204.2	197.29	20			100	513.4	505.39	30		
40	209.3	202.34	20			110	563.9	555.92	30		
41	214.8	207.39	20			114	584.1	576.13	30		
42	219.9	212.44	20			120	614.4	606.45	30		
43	224.9	217.49	20			125	639.7	631.51	30		

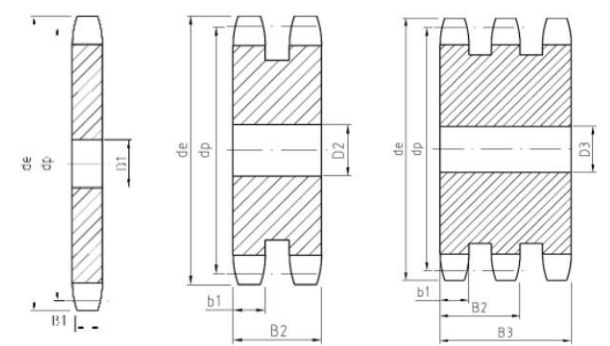

PITCH 5/8" X3/8"

For Chain
Acc. to DIN 8188 **ASA 50**
ISO/R 606

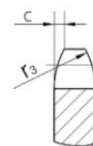

PLATEWHEELS mm

Tooth radius r ₃	17
Radius width C	2
Tooth width B ₁	9
Tooth width b ₁	8.8
Tooth width B ₂	26.9
Tooth width B ₃	45

CHAIN mm

Pitch	15.875
Internal width	9.52
Roller Φ	10.16

SPROCKETS			SIMPLEX			DUPLEX			TRIPLEX		
Z	d _e	d _p	d _m	D ₁	A	d _m	D ₂	A	d _m	D ₃	A
10	71.54	61.64	42	12	30	42	12	45			
11	77.51	67.61	45	12	30	47	16	50			
12	83.49	73.61	45	12	30	53	16	50	53	20	70
13	89.49	79.59	58	14	35	59	16	50	59	20	70
14	95.50	85.61	60	14	35	65	16	50	65	20	70
15	101.52	91.63	60	14	35	71	16	50	71	20	70
16	107.54	97.65	75	16	35	77	20	50	77	20	70
17	113.56	103.67	75	16	35	83	20	50	83	20	70
18	119.59	109.71	75	16	35	89	20	50	89	20	70
19	125.63	115.75	80	16	35	95	20	50	95	20	70
20	131.67	121.78	80	16	35	100	20	50	100	20	70
21	137.71	127.82	80	16	35	100	20	50	100	20	70
22	143.75	133.86	90	20	40	100	20	50	100	20	70
23	149.79	139.90	90	20	40	110	20	50	110	20	70
24	155.84	145.94	90	20	40	110	20	50	110	20	70
25	161.88	152.00	90	20	40	120	20	50	120	20	70
26	167.93	158.04	90	20	40	120	20	50			
27	173.98	164.09	90	20	40	120	20	50			
28	180.03	170.13	95	20	40	120	20	50			
30	192.14	182.25	95	20	40	120	20	50			

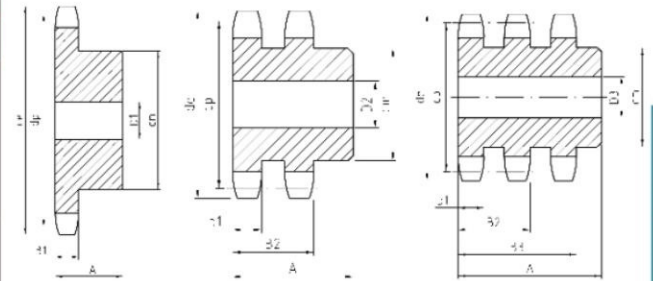

Sprockets
Platewheels

PITCH 3/4" X1/2"

For Chain
Acc. to DIN 8188 ASA 60
ISO/R 606

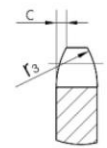

SPROCKETS	mm
Tooth radius r ₃	20
Radius width C	2.4
Tooth width B ₁	12.0
Tooth width b ₁	11.8
Tooth width B ₂	34.6
Tooth width B ₃	57.4

CHAIN	mm
Pitch	19.05
Internal width	12.7
Roller φ	11.91
Material: C45	

PLATEWHEELS			S	D	T
Z	d _e	d _p	D ₁	D ₂	D ₃
30	192.14	182.25			20
32	204.24	194.35		20	
38	240.58	230.69	20	25	25
40	252.69	242.80	20	25	
45	282.98	273.09	25	25	25
48	301.16	291.27	25		
57	355.70	345.81	25	25	30
76	470.87	460.98	30	30	30
95	586.06	576.17		30	

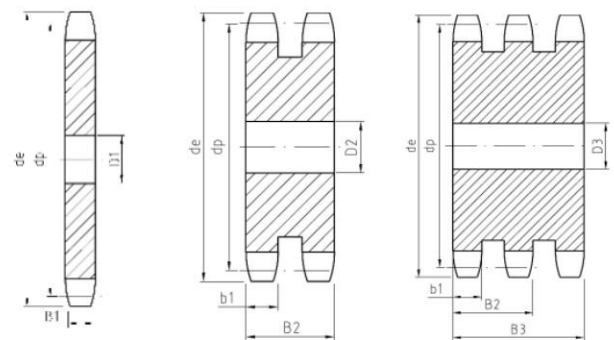

PITCH 3/4" X1/2"

For Chain
Acc. to DIN 8188 ASA 60
ISO/R 606

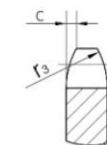

PLATEWHEELS	mm
Tooth radius r ₃	20
Radius width C	2.4
Tooth width B ₁	12.0
Tooth width b ₁	11.8
Tooth width B ₂	34.6
Tooth width B ₃	57.4

CHAIN	mm
Pitch	19.05
Internal width	12.7
Roller φ	11.91

ASA80 | ASA Sprockets & Platewheels



Sprockets
Platewheels

SPROCKETS			SIMPLEX			DUPLEX			TRIPLEX		
Z	d _e	d _p	d _m	D ₁	A	d _m	D ₂	A	d _m	D ₃	A
8	79.49	66.37	42	16	35						
9	87.38	74.27	50	16	35						
10	95.32	82.19	55	16	35						
11	103.28	90.14	61	16	40						
12	111.26	98.14	69	16	40	72	20	70	72	25	100
13	119.26	106.12	78	16	40	78	20	70	78	25	100
14	127.27	114.15	84	16	40	86	20	70	86	25	100
15	135.29	122.17	92	16	40	94	20	70	94	25	100
16	143.32	130.20	100	20	45	102	20	70	102	30	100
17	151.35	138.22	100	20	45	110	20	70	110	30	100
18	159.39	148.28	100	20	45	118	20	70	118	30	100
19	167.44	154.33	100	20	45	126	20	70	126	30	100
20	175.49	162.38	100	20	45	130	20	70	130	30	100
21	183.54	170.43	110	20	50	130	25	70			
22	191.60	178.48	110	20	50						
23	199.66	186.53	110	20	50						
24	207.72	194.59	110	20	50						
25	215.78	202.66	110	20	50						
26	223.84	210.72	120	20	50						
27	231.91	218.79	120	20	50						
28	239.98	226.85	120	20	50						
29	248.05	234.92	120	20	50						
30	256.12	243.00	120	20	50						

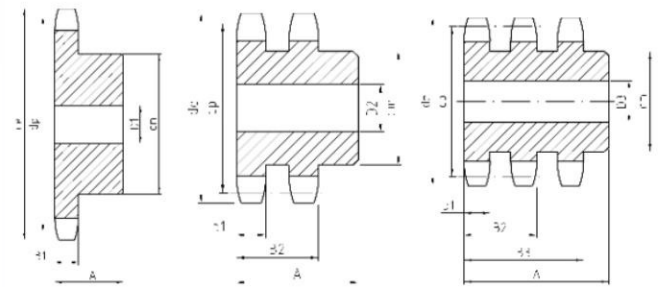

PITCH 1" X5/8"

For Chain
Acc. to DIN 8188 ASA 80
ISO/R 606

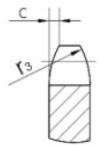

SPROCKETS mm

Tooth radius r ₃	27
Radius width C	3.2
Tooth width B ₁	15.0
Tooth width b ₁	14.7
Tooth width B ₂	44.0
Tooth width B ₃	73.3

CHAIN mm

Pitch	25.4
Internal width	15.88
Roller Φ	15.88
Material: C45	

PLATEWHEELS			S	D	T
Z	d _e	d _p	D ₁	D ₂	D ₃
10	95.32	82.19	15		
11	103.28	90.14	15		
12	111.26	98.14	15		
13	119.26	106.12	15		
14	127.27	114.15	15		
15	135.29	122.17	15		
16	143.32	130.20	19		
17	151.35	138.22	19		
18	159.39	146.28	19		
19	167.44	154.33	19		
20	175.49	162.38	19		
21	183.54	170.43	20		
22	191.60	178.48	20		
23	199.66	186.53	20		
24	207.72	194.59	20		
25	215.78	202.56	20	25	30
26	223.84	210.72	20		
27	231.91	218.79	20		
28	239.98	226.85	20		
30	256.12	243.00	20	25	30
32	272.26	259.13	25		
35	296.48	283.36	25		
38	320.70	307.59	25	25	30
45	377.24	364.12	25	25	30
50	417.64	404.52	25		
57	474.20	461.08	25	25	40
76	627.80	614.64	25	25	40

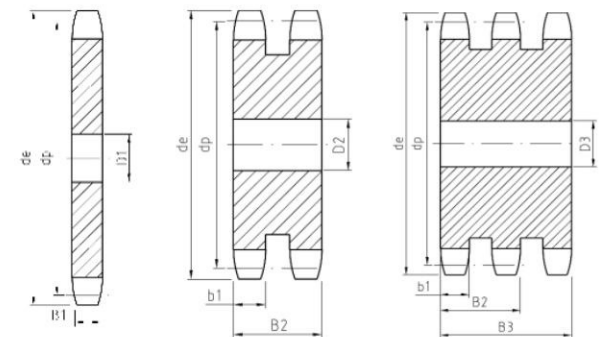

PITCH 1" X5/8"

For Chain
Acc. to DIN 8188 ASA 80
ISO/R 606

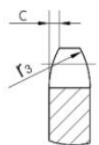

PLATEWHEELS mm

Tooth radius r ₃	27
Radius width C	3.2
Tooth width B ₁	15.0
Tooth width b ₁	14.7
Tooth width B ₂	44.0
Tooth width B ₃	73.3

CHAIN mm

Pitch	25.4
Internal width	15.88
Roller Φ	15.88

SPROCKETS			SIMPLEX			DUPLEX		
Z	d _e	d _p	d _m	D ₁	A	d _m	D ₂	A
8	98.1	82.96	53	20	40			
9	108.0	92.84	63	20	40			
10	117.9	102.74	70	20	40			
11	127.8	112.68	77	20	45			
12	137.8	122.68	88	20	45	90	20	80
13	147.8	132.65	98	20	45	100	20	80
14	157.8	142.68	108	20	45	110	20	80
15	167.9	152.72	118	20	45	120	20	80
16	177.9	162.75	120	25	50	120	25	80
17	187.9	172.78	120	25	50	120	25	80
18	198.0	182.85	120	25	50			
19	208.1	192.91	120	25	50			
20	218.1	202.98	120	25	50			
21	228.2	213.04	140	25	55			
22	238.3	233.11	140	25	55			
23	248.3	233.17	140	25	55			
24	258.4	243.23	140	25	55			
25	268.5	253.33	140	25	55			

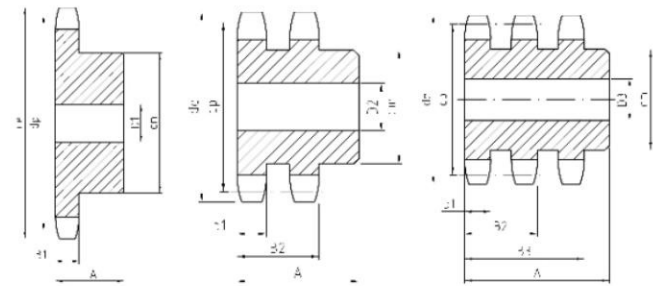

PITCH 1" 1/4X3/4"

For Chain
Acc. to DIN 8188 **ASA 100**
ISO/R 606

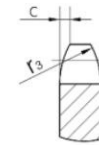

SPROCKETS	mm
Tooth radius r ₃	33.5
Radius width C	4
Tooth width B ₁	18.0
Tooth width b ₁	17.7
Tooth width B ₂	53.5
Tooth width B ₃	89.2

CHAIN	mm
Pitch	31.75
Internal width	19.05
Roller Φ	19.05
Material: C45	

PLATEWHEELS			S	D	T
Z	d _e	d _p	D ₁	D ₂	D ₃
8	98.1	82.96	16		
9	108.0	92.84	16		
10	117.9	102.74	16		
11	127.8	112.68	16		
12	137.8	122.68	20		
13	147.8	132.65	20		
14	157.8	142.68	20		
15	167.9	152.72	20		
16	177.9	162.75	20	25	
17	187.9	172.78	20	25	
18	198.0	182.85	20		
19	208.1	192.91	20		
20	218.1	202.98	20	25	
21	228.2	213.04	25		
22	238.3	233.11	25		
23	248.3	233.17	25		
24	258.4	243.23	25		
25	268.5	253.33	25	25	
26	278.6	263.40	25		
27	288.6	273.40	25		
28	298.7	283.56	25		
29	308.8	293.65	25		
30	318.9	303.75	25	25	
31	329.0	313.85	25		
32	339.1	323.91	25		
33	349.2	334.01	25		
34	359.3	344.10	25		
35	369.4	354.20	25		
36	379.5	364.30	25		
37	389.5	374.39	25		
38	399.6	384.49	25	30	
39	409.7	394.59	25		
40	419.8	404.68	25		
45	470.3	455.17	30	30	
57	591.5	576.36	30	30	

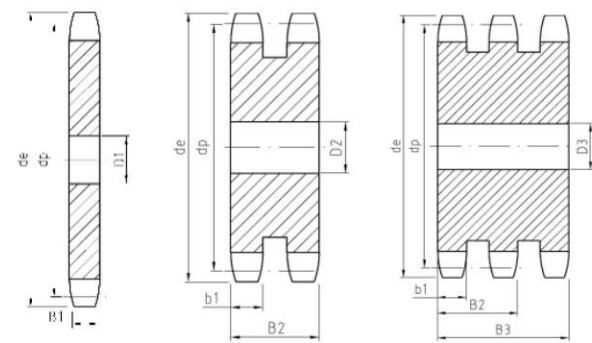

PITCH 1" 1/4X3/4"

For Chain
Acc. to DIN 8188 **ASA 100**
ISO/R 606

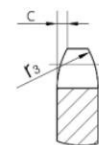

PLATEWHEELS	mm
Tooth radius r ₃	33.5
Radius width C	4
Tooth width B ₁	18.0
Tooth width b ₁	17.7
Tooth width B ₂	53.5
Tooth width B ₃	89.2

CHAIN	mm
Pitch	31.75
Internal width	19.05
Roller Φ	19.05

SPROCKETS			SIMPLEX			DUPLEX		
Z	d _e	d _p	d _m	D ₁	A	d _m	D ₂	A
8	119.04	99.55	58	20	45			
9	130.88	111.40	70	20	45			
10	142.77	123.29	80	20	45			
11	154.71	135.21	90	25	50			
12	166.69	147.22	102	25	50	102	25	100
13	178.68	159.18	114	25	50	114	25	100
14	190.70	171.22	128	25	50	128	25	100
15	202.73	183.26	140	25	50	140	25	100
PLATEWHEELS			SIMPLEX			DUPLEX		
Z	d _e	d _p		D ₁			D ₂	
16	214.77	195.29		25				
17	226.83	207.35		25			25	
18	238.89	219.41		25			25	
20	263.03	243.55		25			25	
22	287.20	267.72		25				
25	323.47	303.99		25			25	
30	383.97	364.49		30			30	
32	408.19	388.71		30				
38	480.85	461.37		30			30	
45	565.67	546.19		30			40	
57	711.10	691.62					40	

PITCH 1" 1/2X1"
 For Chain **ASA 120**
 Acc. to DIN 8188
 ISO/R 606

SPROCKETS & PLATEWHEELS mm

Tooth radius r ₃	40.5
Radius width C	4.8
Tooth width B ₁	24.1
Tooth width b ₁	23.6
Tooth width B ₂	69.0
B ₃	114.5

CHAIN mm

Pitch	38.1
Internal width	25.4
Roller Φ	22.22
Material: C45	

ALL toothings not mentioned any longer are available until sold out. Toothings and pitches of ASA profiles not included in this Catalog can be manufactured upon request.