

03A-1 | Platewheels



Platewheels

Z	d _e	d _p	S	
			D ₁	
8	15.2	13.06	4	
9	16.8	14.62	4	
10	18.3	16.18	4	
11	19.9	17.15	5	
12	21.5	19.32	5	
13	23.0	20.89	5	
14	24.6	22.47	5	
15	26.2	24.04	5	
16	27.8	25.63	6	
17	29.4	27.20	6	
18	30.9	28.79	6	
19	32.5	30.38	6	
20	34.1	31.96	6	
21	35.7	33.54	8	
22	37.3	35.13	8	
23	38.9	36.72	8	
24	40.5	38.30	8	
25	42.0	39.89	8	
26	43.6	41.48	8	
27	45.2	43.07	8	
28	46.8	44.65	8	
29	48.4	46.25	8	
30	50.0	47.83	8	
31	51.6	49.42	8	
32	53.2	51.01	8	
33	54.8	52.60	8	
34	56.3	54.19	8	
35	57.9	55.78	8	
36	59.5	57.37	8	
37	61.1	58.96	8	
38	62.7	60.54	8	
39	64.3	62.13	8	
40	65.9	63.73	8	
41	67.5	65.30	8	
42	69.1	66.91	8	
43	70.6	68.49	8	
44	72.2	70.09	8	
45	73.8	71.68	8	
46	75.4	73.27	8	
47	77.0	74.86	8	
48	78.6	76.45	8	
49	80.2	78.03	8	
50	81.8	79.63	8	
51	83.4	81.22	10	
52	85.0	82.81	10	
53	86.6	84.40	10	
54	88.1	85.97	10	
55	89.7	87.58	10	
56	91.3	89.17	10	
57	92.9	90.76	10	
58	94.5	92.35	10	
59	96.1	93.94	10	
60	97.7	95.53	10	
62	100.9	98.72	12	
64	104.1	101.90	12	
65	105.6	103.49	12	
66	107.2	105.08	12	
68	110.4	108.26	12	
70	113.6	111.44	12	
72	116.8	114.63	12	
75	121.6	119.40	12	
76	123.1	120.99	12	
78	126.3	124.17	12	
80	129.5	127.35	12	
85	137.5	135.31	14	
90	145.4	143.27	14	
95	153.4	151.22	14	
100	161.3	159.18	14	
110	177.2	175.09	14	
114	183.6	181.45	14	
120	193.2	191.01	14	
125	201.1	198.96	14	

PLATEWHEELS 5X2.5mm

For chain Acc. to DIN 8187
ISO/R 606

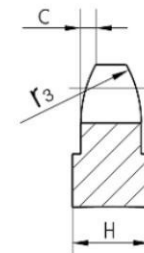
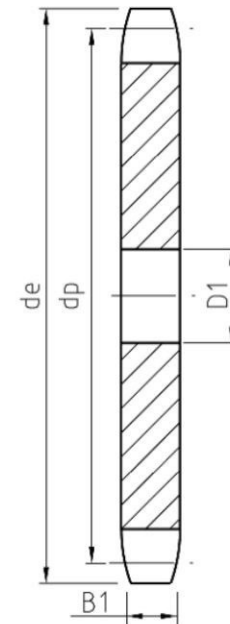

PLATEWHEELS mm

Tooth radius r ₃	5
Radius width C	0.6
Tooth width B ₁	2.3

CHAIN mm

Pitch	5
Internal width	2.5
Roller Φ	3.2

H=4mm, From Z=51 the width of the plate is increased

04A-1 | Platewheels



Platewheels

Z	d _e	d _p	S
			D ₁
8	18.0	15.67	5
9	19.9	17.54	5
10	21.7	19.42	6
11	23.6	21.30	6
12	25.4	23.18	6
13	27.3	25.05	8
14	29.2	26.96	8
15	31.0	28.86	8
16	33.0	30.76	8
17	35.0	32.65	8
18	36.9	34.55	8
19	38.8	36.44	8
20	40.7	38.34	8
21	42.6	40.25	8
22	44.5	42.16	8
23	46.4	44.06	8
24	48.3	45.96	8
25	50.2	47.87	8
26	52.1	49.76	8
27	54.0	51.67	8
28	55.9	53.58	8
29	57.8	55.50	8
30	59.8	57.42	8
31	61.7	59.31	8
32	63.6	61.21	8
33	65.5	63.11	8
34	67.4	65.02	8
35	69.3	66.93	8
36	71.2	68.84	8
37	73.1	70.75	8
38	75.0	72.66	8
39	76.9	74.57	8
40	78.9	76.47	8
41	80.8	78.38	10
42	82.7	80.28	10
43	84.7	82.19	10
44	86.6	84.10	10
45	88.5	86.01	10
46	90.4	87.92	10
47	92.3	89.93	10
48	94.2	91.74	10
49	96.1	93.64	10
50	98.0	95.55	10
51	99.9	97.46	12
52	101.8	99.37	12
53	103.7	101.27	12
54	105.6	103.17	12
55	107.6	105.08	12
56	109.5	107.00	12
57	111.4	108.93	12
58	113.3	110.82	12
59	115.2	112.71	12
60	117.1	114.62	12
62	120.9	118.45	14
64	124.7	122.27	14
65	126.6	124.18	14
66	128.5	126.09	14
68	132.4	129.91	14
70	136.2	133.73	14
72	140.0	137.55	16
75	145.7	143.28	16
76	147.6	145.19	16
78	151.5	149.01	16
80	155.3	152.82	16
85	164.8	162.37	16
90	174.4	171.92	16
95	183.9	181.47	16
100	193.5	191.01	16
110	212.6	210.11	16
114	220.2	217.75	16
120	231.7	229.20	16
125	241.2	238.75	16

PLATEWHEELS 6X2.8mm

For chain Acc. to DIN 8187
ISO/R 606

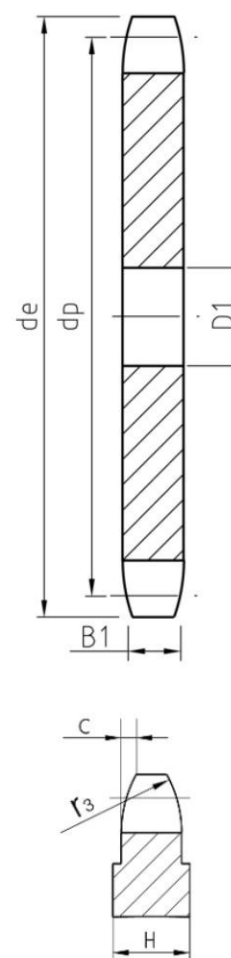

PLATEWHEELS mm

Tooth radius r ₃	6
Radius width C	0.7
Tooth width B ₁	2.6

CHAIN mm

Pitch	6
Internal width	2.8
Roller ϕ	4

H=4mm, From Z=51 the width of the plate is increased

05A-1-2 | Platewheels



Platewheels

Z	d _e	d _p	S		D	
			D ₁	D ₂	D ₁	D ₂
8	24.0	20.90	6	8	8	8
9	26.6	23.39	6	8	8	8
10	29.2	25.89	8	8	8	8
11	31.7	28.39	8	8	8	8
12	34.2	30.91	8	8	8	8
13	36.7	33.42	8	8	8	8
14	39.2	35.95	8	8	8	8
15	41.7	38.48	8	8	8	8
16	44.3	41.01	8	8	10	10
17	46.8	43.53	8	8	10	10
18	49.3	46.07	8	8	10	10
19	51.9	48.61	8	8	10	10
20	54.4	51.14	8	8	10	10
21	57.0	53.68	8	8	10	10
22	59.5	56.21	8	8	10	10
23	62.0	58.75	8	8	10	10
24	64.6	61.29	8	8	10	10
25	67.5	63.83	8	8	10	10
26	69.5	66.37	10	10	12	12
27	72.2	68.91	10	10	12	12
28	74.8	71.45	10	10	12	12
29	77.3	73.99	10	10	12	12
30	79.8	76.53	10	10	12	12
31	82.4	79.08	10	10	12	12
32	84.9	81.61	10	10	12	12
33	87.5	84.16	10	10	12	12
34	90.0	86.70	10	10	12	12
35	92.5	89.25	10	10	12	12
36	95.0	91.79	10	10	12	12
37	97.6	94.33	10	10	12	12
38	100.2	96.88	10	10	12	12
39	102.7	99.42	10	10	12	12
40	105.3	101.97	10	10	12	12
41	107.8	104.51	12	12	14	14
42	110.4	107.05	12	12	14	14
43	112.9	109.60	12	12	14	14
44	115.5	112.14	12	12	14	14
45	118.0	114.69	12	12	14	14
46	120.6	117.23	12	12	14	14
47	123.1	119.77	12	12	14	14
48	125.6	122.32	12	12	14	14
49	128.2	124.86	12	12	14	14
50	130.7	127.41	12	12	14	14
51	133.3	129.95	14	14	16	16
52	135.8	132.49	14	14	16	16
53	138.4	135.04	14	14	16	16
54	140.9	137.59	14	14	16	16
55	143.5	140.13	14	14	16	16
56	146.0	142.68	14	14	16	16
57	148.6	145.22	14	14	16	16
58	151.0	147.77	14	14	16	16
59	153.6	150.31	14	14	16	16
60	156.2	152.86	14	14	16	16
62	162.0	157.95	16	16	20	20
64	167.1	163.04	16	16	20	20
65	169.6	165.58	16	16	20	20
66	172.2	168.13	16	16	20	20
68	177.3	173.22	16	16	20	20
70	182.4	178.31	16	16	20	20
72	187.5	183.40	20	20	20	20
75	195.1	191.04	20	20	20	20
76	197.7	193.59	20	20	20	20
78	202.8	198.68	20	20	20	20
80	207.9	203.77	20	20	20	20
85	220.6	216.50	20	20	20	20
90	233.4	229.23	20	20	20	20
95	246.1	241.96	20	20	20	20
100	258.9	254.68	20	20	20	20
110	284.3	280.15	20	20	20	20
114	294.5	290.33	20	20	20	20
120	310.0	305.61	20	20	20	20
125	322.5	318.34	20	20	20	20

PLATEWHEELS 8X3mm

For chain Acc. to DIN 8187
ISO/R 606

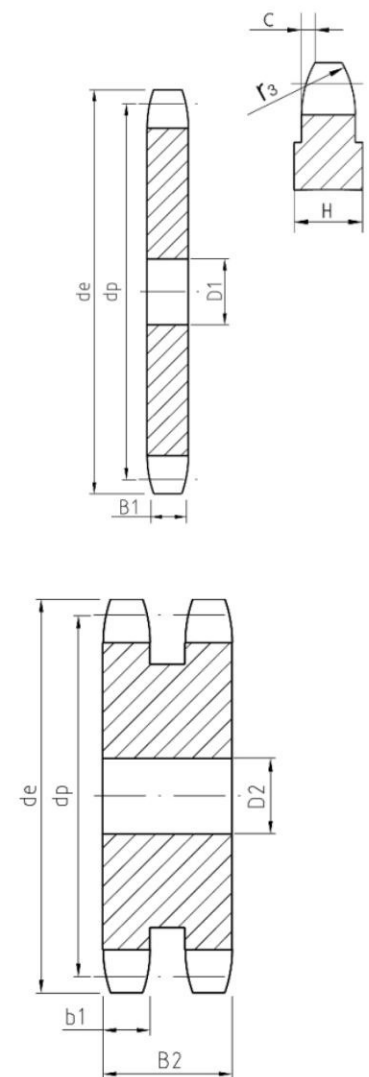
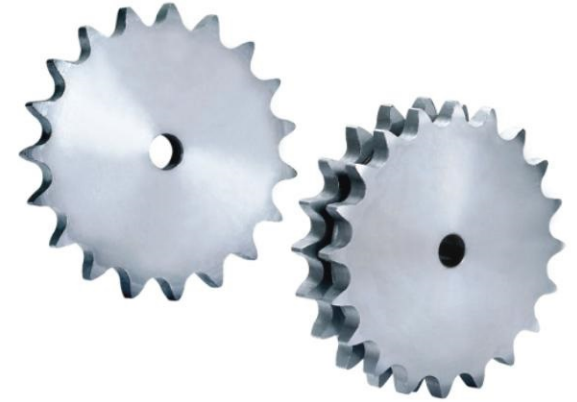

PLATEWHEELS mm

Tooth radius r ₃	8
Radius width C	1.0
Tooth width B ₁	2.8
Tooth width b ₁	2.7
Tooth width B ₂	8.3

CHAIN mm

Pitch	8
Internal width	3
Roller Φ	5

H=4mm, From Z=46 the width of the plate is increased

06A-1-2-3 | Platewheels



Platewheels

Z	d _e	d _p	S	D	T
			D ₁	D ₂	D ₃
8	28.0	24.89	6	8	8
9	31.0	27.85	8	8	8
10	34.0	30.82	8	8	10
11	37.0	33.80	8	10	10
12	40.0	36.80	8	10	10
13	43.0	39.79	8	10	10
14	46.3	42.80	8	10	12
15	49.3	45.81	8	10	12
16	52.3	48.82	10	12	12
17	55.3	51.83	10	12	12
18	58.3	54.85	10	12	12
19	61.3	57.87	10	12	12
20	64.3	60.89	10	12	12
21	68.0	63.91	10	12	14
22	71.0	66.93	10	12	14
23	73.5	69.95	10	12	14
24	77.0	72.97	10	12	14
25	80.0	76.02	10	12	14
26	83.0	79.02	10	12	14
27	86.0	82.02	10	12	14
28	89.0	85.07	10	12	14
29	92.0	88.09	10	12	14
30	94.7	91.12	10	12	14
31	98.3	94.15	12	14	16
32	101.3	97.17	12	14	16
33	104.3	100.20	12	14	16
34	107.3	103.23	12	14	16
35	110.4	106.26	12	14	16
36	113.4	109.29	12	14	16
37	116.4	112.32	12	14	16
38	119.5	115.35	12	14	16
39	122.5	118.37	12	14	16
40	125.5	121.40	12	14	16
41	128.5	124.43	16	16	16
42	131.6	127.46	16	16	16
43	134.6	130.49	16	16	16
44	137.6	133.52	16	16	16
45	140.7	136.55	16	16	16
46	143.7	139.58	16	16	16
47	146.7	142.61	16	16	16
48	149.7	145.64	16	16	16
49	152.7	148.66	16	16	16
50	155.7	151.69	16	16	16
51	158.7	154.72	16	16	20
52	161.8	157.75	16	16	20
53	164.8	160.78	16	16	20
54	167.8	163.82	16	16	20
55	170.8	166.85	16	16	20
56	173.8	169.88	16	16	20
57	176.9	172.91	16	16	20
58	179.9	175.93	16	16	20
59	183.0	178.96	16	16	20
60	186.0	181.99	16	16	20
62	192.1	188.06	20	20	20
64	198.2	194.12	20	20	20
65	201.6	197.15	20	20	20
66	204.6	200.18	20	20	25
68	210.7	206.24	20	20	25
70	216.7	212.30	20	20	25
72	222.8	218.37	20	20	25
75	231.9	227.46	20	20	25
76	234.9	230.49	20	20	25
78	241.0	236.55	20	20	25
80	247.1	242.61	20	20	25
85	262.2	257.77	20	20	25
90	277.4	272.93	20	20	25
95	292.5	288.08	20	20	25
100	307.7	303.25	20	20	25
110	338.0	333.55	20	20	25
114	349.5	345.68	20	20	25
120	368.3	363.86	20	20	25
125	383.5	379.02	20	20	25

PLATEWHEELS 3/8" X7/32"

For chain Acc. to DIN 8187
ISO/R 606

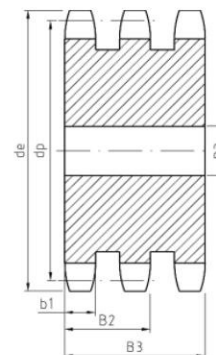
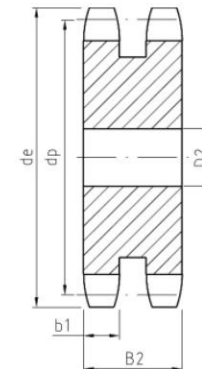
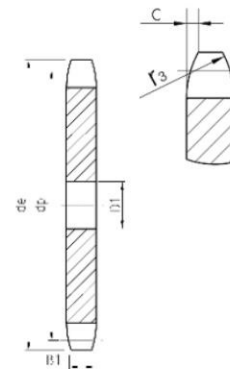

PLATEWHEELS mm

Tooth radius r ₃	10
Radius width C	1
Tooth width B ₁	5.3
Tooth width b ₁	5.2
Tooth width B ₂	15.4
Tooth width B ₃	25.6

CHAIN mm

Pitch	9.525
Internal width	5.72
Roller φ	6.35

H=4mm, From Z=100 the width of the plate is increased

081A-1 | Platewheels



Platewheels

Z	d _e	d _p	S			
			D ₁			
8	37.2	33.18	8			
9	41.5	37.13	8			
10	46.2	41.10	8			
11	49.6	45.07	8			
12	53.9	49.07	8			
13	58.4	53.06	8			
14	62.8	57.07	8			
15	66.8	61.09	8			
16	70.9	65.10	8			
17	74.9	69.11	8			
18	78.9	73.14	8			
19	82.9	77.16	8			
20	86.9	81.19	8			
21	91.0	85.22	8			
22	95.0	89.24	10			
23	99.0	93.27	10			
24	103.0	97.29	10			
25	107.1	101.33	10			
26	111.2	105.36	12			
27	115.4	109.40	12			
28	119.4	113.42	12			
29	123.4	117.46	12			
30	127.5	121.50	12			
31	131.5	125.54	12			
32	135.5	129.56	12			
33	139.6	133.60	12			
34	143.6	137.64	12			
35	147.6	141.68	12			
36	151.7	145.72	16			
37	155.7	149.76	16			
38	159.8	153.80	16			
39	163.8	157.83	16			
40	167.8	161.87	16			
41	171.4	165.91	16			
42	175.4	169.95	16			
43	179.5	173.99	16			
44	183.5	178.03	16			
45	187.5	182.07	16			
46	191.6	186.10	20			
47	195.6	190.14	20			
48	199.7	194.18	20			
49	203.7	198.22	20			
50	207.8	202.26	20			
51	211.8	206.30	20			
52	215.9	210.34	20			
53	219.9	214.37	20			
54	224.0	218.43	20			
55	228.0	222.46	20			
56	232.1	226.50	20			
57	236.1	230.54	20			
58	240.2	234.58	20			
59	244.2	238.62	20			
60	248.2	242.66	20			
62	256.7	250.75	20			
64	264.8	258.82	20			
65	268.8	262.86	20			
66	272.9	266.90	25			
68	280.9	274.99	25			
70	289.0	283.07	25			
72	297.1	291.16	25			
76	313.3	307.33	25			
78	321.4	315.40	25			
80	329.4	323.48	25			
85	349.7	343.70	25			
90	369.9	363.90	25			
95	390.1	384.10	25			
100	410.3	404.31	25			
110	450.7	444.74	25			
114	466.9	460.90	25			
120	491.2	485.16	25			
125	511.4	505.37	25			

PLATEWHEELS 1/2" X1/8"

For chain Acc. to DIN 8187
ISO/R 606

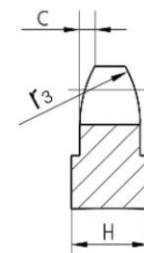
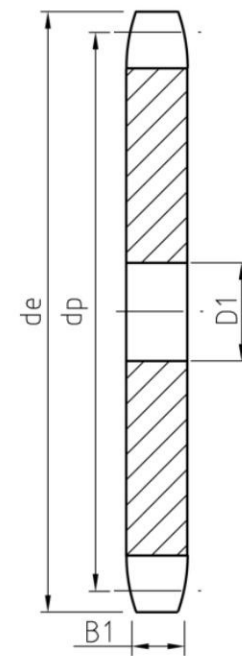

PLATEWHEELS mm

Tooth radius r ₃	13
Radius width C	1.3
Tooth width B ₁	3

CHAIN mm

Pitch	12.7
Internal width	3.3
Roller Φ	7.75

H=4mm, From Z=30 the width of the plate is increased
H=6mm, From Z=90 the width of the plate is increased

083A-1/084A-1 | Platewheels



Platewheels

Z	d _e	d _p	S			
			D ₁			
8	38.5	33.18	8			
9	41.5	37.13	8			
10	46.2	41.10	8			
11	49.6	45.07	8			
12	53.9	49.07	8			
13	58.4	53.06	8			
14	62.8	57.07	8			
15	66.8	61.09	8			
16	70.9	65.10	8			
17	74.9	69.11	8			
18	78.9	73.14	8			
19	82.9	77.16	8			
20	86.9	81.19	8			
21	91.0	85.22	8			
22	95.0	89.24	10			
23	99.0	93.27	10			
24	103.0	97.29	10			
25	107.1	101.33	10			
26	111.2	105.36	12			
27	115.4	109.40	12			
28	119.4	113.42	12			
29	123.4	117.46	12			
30	127.5	121.50	12			
31	131.5	125.54	12			
32	135.5	129.56	12			
33	139.6	133.60	12			
34	143.6	137.64	12			
35	147.6	141.68	12			
36	151.7	145.72	16			
37	155.7	149.76	16			
38	159.8	153.80	16			
39	163.8	157.83	16			
40	167.8	161.87	16			
41	171.4	165.91	16			
42	175.4	169.95	16			
43	179.5	173.99	16			
44	183.5	178.03	16			
45	187.5	182.07	16			
46	191.6	186.10	20			
47	195.6	190.14	20			
48	199.7	194.18	20			
49	203.7	198.22	20			
50	207.8	202.26	20			
51	211.8	206.30	20			
52	215.9	210.34	20			
53	219.9	214.37	20			
54	224.0	218.43	20			
55	228.0	222.46	20			
56	232.1	226.50	20			
57	236.1	230.54	20			
58	240.2	234.58	20			
59	244.2	238.62	20			
60	248.2	242.66	20			
62	256.7	250.75	20			
64	264.8	258.82	20			
65	268.8	262.86	20			
66	272.9	266.90	25			
68	280.9	274.99	25			
70	289.0	283.07	25			
72	297.1	291.16	25			
76	313.3	307.33	25			
78	321.4	315.40	25			
80	329.4	323.48	25			
85	349.7	343.70	25			
90	369.9	363.90	25			
95	390.1	384.10	25			
100	410.3	404.31	25			
110	450.7	444.74	25			
114	466.9	460.90	25			
120	491.2	485.16	25			
125	511.4	505.37	25			

PLATEWHEELS 1/2" X3/16"

For chain Acc. to DIN 8187
ISO/R 606

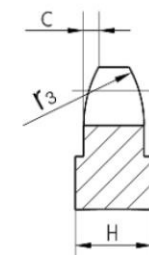
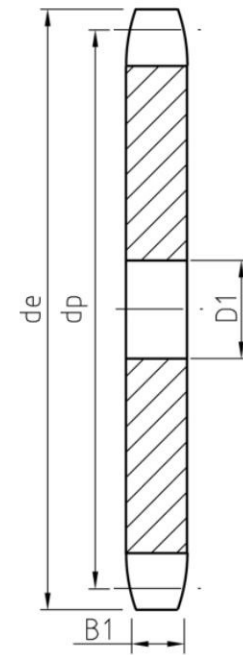

PLATEWHEELS mm

Tooth radius r ₃	13
Radius width C	1.3
Tooth width B ₁	4.5

CHAIN mm

Pitch	12.7
Internal width	4.88
Roller Φ	7.75

H=6mm, From Z=90 the width of the plate is increased

085A-1 | Platewheels



Platewheels

Z	d _e	d _p	S			
			D ₁			
8	38.5	33.18	8			
9	41.5	37.13	8			
10	46.2	41.10	8			
11	49.6	45.07	8			
12	53.9	49.07	8			
13	58.4	53.06	8			
14	62.8	57.07	8			
15	66.8	61.09	8			
16	70.9	65.10	8			
17	74.9	69.11	8			
18	78.9	73.14	8			
19	82.9	77.16	8			
20	86.9	81.19	8			
21	91.0	85.22	10			
22	95.0	89.24	10			
23	99.0	93.27	10			
24	103.0	97.29	10			
25	107.1	101.33	10			
26	111.2	105.36	12			
27	115.4	109.40	12			
28	119.4	113.42	12			
29	123.4	117.46	12			
30	127.5	121.50	12			
31	131.5	125.54	12			
32	135.5	129.56	12			
33	139.6	133.60	12			
34	143.6	137.64	12			
35	147.6	141.68	12			
36	151.7	145.72	16			
37	155.7	149.76	16			
38	159.8	153.80	16			
39	163.8	157.83	16			
40	167.8	161.87	16			
41	171.4	165.91	16			
42	175.4	169.95	16			
43	179.5	173.99	16			
44	183.5	178.03	16			
45	187.5	182.07	16			
46	191.6	186.10	20			
47	195.6	190.14	20			
48	199.7	194.18	20			
49	203.7	198.22	20			
50	207.8	202.26	20			
51	211.8	206.30	20			
52	215.9	210.34	20			
53	219.9	214.37	20			
54	224.0	218.43	20			
55	228.0	222.46	20			
56	232.1	226.50	20			
57	236.1	230.54	20			
58	240.2	234.58	20			
59	244.2	238.62	20			
60	248.2	242.66	20			
62	256.7	250.75	20			
64	264.8	258.82	20			
65	268.8	262.86	20			
66	272.9	266.90	25			
68	280.9	274.99	25			
70	289.0	283.07	25			
72	297.1	291.16	25			
76	313.3	307.33	25			
78	321.4	315.40	25			
80	329.4	323.48	25			
85	349.7	343.70	25			
90	369.9	363.90	25			
95	390.1	384.10	25			
100	410.3	404.31	25			
110	450.7	444.74	25			
114	466.9	460.90	25			
120	491.2	485.16	25			
125	511.4	505.37	25			

PLATEWHEELS 1/2" X1/4" Roller7.75

For chain Acc. to DIN 8187
ISO/R 606

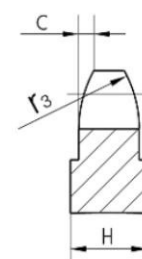
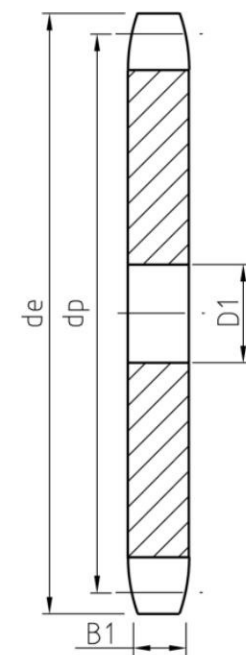

PLATEWHEELS mm

Tooth radius r ₃	13
Radius width C	1.3
Tooth width B ₁	5.9

CHAIN mm

Pitch	12.7
Internal width	6.4
Roller Φ	7.75

086A-1 | Platewheels



Z	d _e	d _p	S			
			D ₁			
8	37.2	33.18	8			
9	41.0	37.13	8			
10	45.2	41.10	8			
11	48.7	45.07	8			
12	53.0	49.07	8			
13	57.4	53.06	8			
14	61.8	57.07	8			
15	65.5	61.09	8			
16	69.5	65.10	10			
17	73.6	69.11	10			
18	77.8	73.14	10			
19	81.7	77.16	10			
20	85.8	81.19	10			
21	89.7	85.22	10			
22	93.8	89.24	10			
23	98.2	93.27	10			
24	101.8	97.29	10			
25	105.8	101.33	10			
26	110.0	105.36	12			
27	114.0	109.40	12			
28	118.0	113.42	12			
29	122.0	117.46	12			
30	126.1	121.50	12			
31	130.2	125.54	12			
32	134.2	129.56	12			
33	138.4	133.60	12			
34	142.6	137.64	12			
35	146.7	141.68	12			
36	151.0	145.72	16			
37	154.6	149.76	16			
38	158.6	153.80	16			
39	162.7	157.83	16			
40	166.8	161.87	16			
41	171.4	165.91	16			
42	175.4	169.95	16			
43	179.7	173.99	16			
44	183.8	178.03	16			
45	188.0	182.07	16			
46	192.1	186.10	20			
47	196.2	190.14	20			
48	200.3	194.18	20			
49	204.3	198.22	20			
50	208.3	202.26	20			
51	212.1	206.30	20			
52	216.1	210.34	20			
53	220.2	214.37	20			
54	224.1	218.43	20			
55	228.1	222.46	20			
56	232.2	226.50	20			
57	236.4	230.54	20			
58	240.5	234.58	20			
59	244.5	238.62	20			
60	248.6	242.66	20			
62	256.9	250.75	20			
64	265.1	258.82	20			
65	269.0	262.86	20			
66	273.0	266.90	25			
68	281.0	274.99	25			
70	289.0	283.07	25			
72	297.2	291.16	25			
76	313.3	307.33	25			
78	321.4	315.40	25			
80	329.4	323.48	25			
85	349.0	343.70	25			
90	369.9	363.90	25			
95	390.1	384.10	25			
100	410.3	404.31	25			
110	450.7	444.74	25			
114	466.9	460.90	25			
120	491.2	485.16	25			
125	511.3	505.37	25			

PLATEWHEELS 1/2" X1/4" ROLLER8.51

For chain Acc. to DIN 8187
ISO/R 606

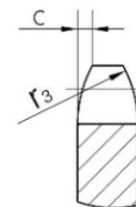
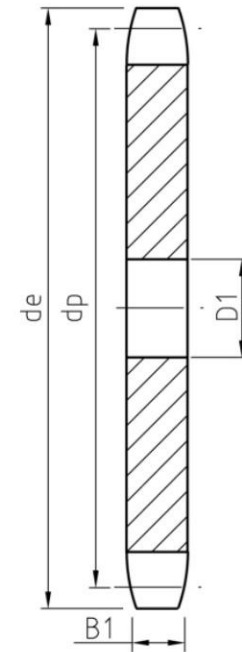

PLATEWHEELS mm

Tooth radius r ₃	13
Radius width C	1.3
Tooth width B ₁	5.9

CHAIN mm

Pitch	12.7
Internal width	6.4
Roller Φ	8.51

08A-1-2-3 | Platewheels



Platewheels

Z	d _e	d _p	S	D	T
			D ₁	D ₂	D ₃
8	37.2	33.18	8	10	10
9	41.0	37.13	8	10	10
10	45.2	41.10	8	10	10
11	48.7	45.07	10	10	12
12	53.0	49.07	10	10	12
13	57.4	53.06	10	10	12
14	61.8	57.07	10	10	12
15	65.5	61.09	10	10	12
16	69.5	65.10	10	12	16
17	73.6	69.11	10	12	16
18	77.8	73.14	10	12	16
19	81.7	77.16	10	12	16
20	85.8	81.19	10	12	16
21	89.7	85.22	12	16	16
22	93.8	89.24	12	16	16
23	98.2	93.27	12	16	16
24	101.8	97.29	12	16	16
25	105.8	101.33	12	16	16
26	110.0	105.36	16	16	16
27	114.0	109.40	16	16	16
28	118.0	113.42	16	16	16
29	122.0	117.46	16	16	16
30	126.1	121.50	16	16	16
31	130.2	125.54	16	16	20
32	134.3	129.56	16	16	20
33	138.4	133.60	16	16	20
34	142.6	137.64	16	16	20
35	146.7	141.68	16	16	20
36	151.0	145.72	16	20	20
37	154.6	149.76	16	20	20
38	158.6	153.80	16	20	20
39	162.7	157.83	16	20	20
40	166.8	161.87	16	20	20
41	171.4	165.91	20	20	25
42	175.4	169.94	20	20	25
43	179.7	173.98	20	20	25
44	183.8	178.03	20	20	25
45	188.0	182.07	20	20	25
46	192.1	186.10	20	20	25
47	196.2	190.14	20	20	25
48	200.3	194.18	20	20	25
49	204.3	198.22	20	20	25
50	208.3	202.26	20	20	25
51	212.1	206.30	20	25	25
52	216.1	210.34	20	25	25
53	220.2	214.37	20	25	25
54	224.1	218.43	20	25	25
55	228.1	222.46	20	25	25
56	232.2	226.50	20	25	25
57	236.4	230.54	20	25	25
58	240.5	234.58	20	25	25
59	244.5	238.62	20	25	25
60	248.6	242.66	20	25	25
62	256.9	250.74	25	25	25
64	265.1	258.82	25	25	25
65	269.0	262.86	25	25	25
66	273.0	266.91	25	25	25
68	281.0	274.99	25	25	25
70	289.0	283.07	25	25	25
72	297.2	291.15	25	25	25
75	309.2	303.28	25	25	25
76	313.3	307.32	25	25	25
78	321.4	315.40	25	25	25
80	329.4	323.49	25	25	25
85	349.0	343.69	25	25	25
90	369.9	363.90	25	25	25
95	390.1	384.11	25	25	25
100	410.3	404.32	25	25	25
110	450.7	444.74	25	25	25
114	466.9	460.91	25	25	25
120	491.2	485.16	25	25	25
125	511.3	505.37	25	25	25

PLATEWHEELS 1/2" X5/16"

For chain Acc. to DIN 8187
ISO/R 606

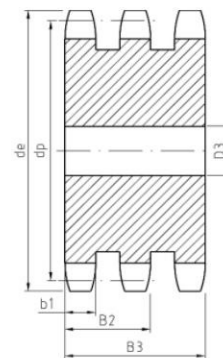
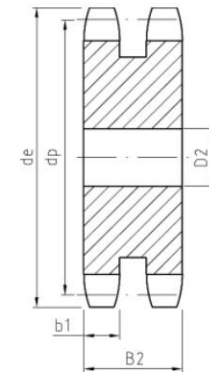
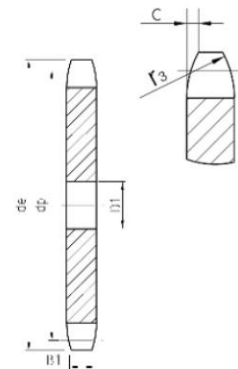

PLATEWHEELS mm

Tooth radius r ₃	13
Radius width C	1.3
Tooth width B ₁	7.2
Tooth width b ₁	7
Tooth width B ₂	21
Tooth width B ₃	34.9

CHAIN mm

Pitch	12.7
Internal width	7.75
Roller φ	8.51

10A-1-2-3 | Platewheels



Platewheels

Z	d _e	d _p	S	D	T
			D ₁	D ₂	D ₃
8	47.0	41.48	10	10	12
9	52.6	46.42	10	10	12
10	57.5	51.37	10	10	12
11	63.0	56.34	10	10	12
12	68.0	61.34	10	10	12
13	73.0	66.32	10	10	12
14	78.0	71.34	10	10	12
15	83.0	76.36	10	12	12
16	88.0	81.37	12	12	16
17	93.0	86.39	12	12	16
18	98.3	91.42	12	12	16
19	103.3	96.45	12	12	16
20	108.4	101.49	12	12	16
21	113.4	106.52	12	16	16
22	118.0	111.55	12	16	16
23	123.5	116.58	12	16	16
24	128.3	121.62	12	16	16
25	134.0	126.66	12	16	16
26	139.0	131.70	16	16	20
27	144.0	136.75	16	16	20
28	148.7	141.78	16	16	20
29	153.8	146.83	16	16	20
30	158.8	151.87	16	16	20
31	163.9	156.92	16	20	20
32	168.9	161.95	16	20	20
33	174.5	167.00	16	20	20
34	179.0	172.05	16	20	20
35	184.1	177.10	16	20	20
36	189.1	182.15	20	20	25
37	194.2	187.20	20	20	25
38	199.2	192.24	20	20	25
39	204.2	197.29	20	20	25
40	209.3	202.34	20	20	25
41	214.8	207.38	20	20	25
42	219.9	212.43	20	20	25
43	224.9	217.48	20	20	25
44	230.0	222.53	20	20	25
45	235.0	227.58	20	20	25
46	240.1	232.63	20	25	25
47	245.1	237.68	20	25	25
48	250.2	242.73	20	25	25
49	255.2	247.78	20	25	25
50	260.3	252.82	20	25	25
51	265.3	257.87	20	25	25
52	270.4	262.92	20	25	25
53	275.4	267.97	20	25	25
54	280.5	273.03	20	25	25
55	285.5	278.08	20	25	25
56	290.6	283.13	25	25	25
57	296.0	288.18	25	25	25
58	300.7	293.23	25	25	25
59	305.7	298.28	25	25	25
60	310.8	303.33	25	25	25
62	321.4	313.43	25	25	30
64	331.5	323.53	25	25	30
65	336.5	328.58	25	25	30
66	341.6	333.64	25	25	30
68	351.7	343.74	25	25	30
70	361.8	353.84	25	25	30
72	371.9	363.94	25	25	30
75	387.1	379.10	25	25	30
76	392.1	384.15	25	25	30
78	402.2	394.25	25	25	30
80	412.3	404.36	25	25	30
85	437.6	429.62	30	30	30
90	462.8	454.88	30	30	30
95	488.5	480.14	30	30	30
100	513.4	505.40	30	30	30
110	563.9	555.92	30	30	30
114	584.1	576.13	30	30	30
120	614.4	606.45	30	30	30
125	639.7	631.51	30	30	30

PLATEWHEELS 5/8" X3/8"

For chain Acc. to DIN 8187
ISO/R 606

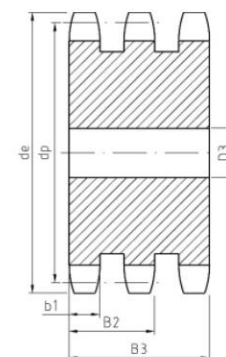
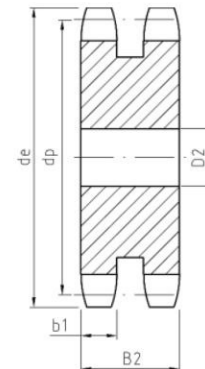
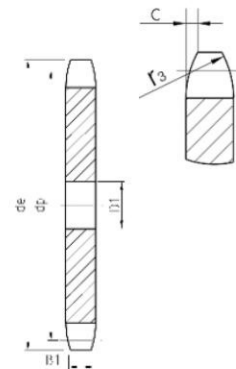

PLATEWHEELS mm

Tooth radius r ₃	16
Radius width C	1.6
Tooth width B ₁	9.1
Tooth width b ₁	9
Tooth width B ₂	25.5
Tooth width B ₃	42.1

CHAIN mm

Pitch	15.875
Internal width	9.65
Roller Φ	10.16

12A-1-2-3 | Platewheels



Platewheels

Z	d _e	d _p	S	D	T
			D ₁	D ₂	D ₃
8	57.6	49.78	10	12	12
9	62.0	55.70	10	12	12
10	69.0	61.64	10	12	12
11	75.0	67.61	12	14	16
12	81.5	73.61	14	14	16
13	87.5	79.59	14	14	16
14	93.6	85.61	14	14	16
15	99.8	91.63	14	14	16
16	105.5	97.65	14	16	16
17	111.5	103.67	14	16	16
18	118.0	109.71	14	16	16
19	124.2	115.75	14	16	16
20	129.7	121.78	14	16	16
21	136.0	127.82	16	16	20
22	141.0	133.86	16	16	20
23	149.0	139.90	16	16	20
24	153.9	145.94	16	16	20
25	160.0	152.00	16	16	20
26	165.9	158.04	16	20	20
27	172.3	164.09	16	20	20
28	178.0	170.13	16	20	20
29	184.1	176.19	16	20	20
30	190.5	182.25	16	20	20
31	196.3	188.31	20	20	25
32	203.3	194.35	20	20	25
33	209.3	200.40	20	20	25
34	214.6	206.46	20	20	25
35	221.0	212.52	20	20	25
36	226.8	218.58	20	25	25
37	232.9	224.64	20	25	25
38	239.0	230.69	20	25	25
39	245.1	236.75	20	25	25
40	251.3	242.81	20	25	25
41	257.3	248.86	25	25	25
42	264.5	254.92	25	25	25
43	270.5	260.98	25	25	25
44	276.5	267.03	25	25	25
45	282.5	273.09	25	25	25
46	287.9	279.15	25	25	25
47	294.0	285.21	25	25	25
48	300.1	291.27	25	25	25
49	306.2	297.33	25	25	25
50	312.3	303.39	25	25	25
51	318.4	309.45	25	25	25
52	324.5	315.51	25	25	25
53	330.5	321.57	25	25	25
54	336.6	327.63	25	25	25
55	342.7	333.69	25	25	25
56	348.7	339.75	25	25	30
57	355.4	345.81	25	25	30
58	361.5	351.87	25	25	30
59	367.5	357.93	25	25	30
60	373.0	363.99	25	25	30
62	385.1	376.12	25	30	30
64	397.2	388.24	25	30	30
65	403.2	394.30	25	30	30
66	409.3	400.36	30	30	30
68	421.4	412.49	30	30	30
70	433.6	424.61	30	30	30
72	447.0	436.73	30	30	30
75	463.9	454.92	30	30	30
76	469.9	460.98	30	30	30
78	482.1	473.10	30	30	30
80	494.2	485.23	30	30	30
85	524.5	515.54	30	30	30
90	554.8	545.85	30	30	30
95	585.1	576.17	30	30	30
100	615.4	606.48	30	30	30
110	676.1	667.11	30	30	30
114	700.6	691.36	30	30	30
120	736.7	727.74	30	30	30
125	767.0	758.06	30	30	30

PLATEWHEELS 3/4" X7/16"

For chain Acc. to DIN 8187
ISO/R 606

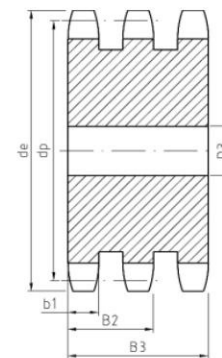
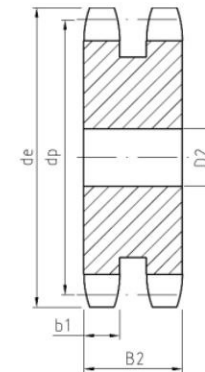
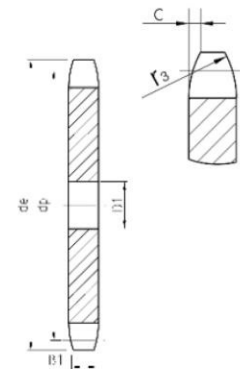

PLATEWHEELS

mm

Tooth radius r ₃	19
Radius width C	2
Tooth width B ₁	11.1
Tooth width b ₁	10.8
Tooth width B ₂	30.3
Tooth width B ₃	49.8

CHAIN

mm

Pitch	19.05
Internal width	11.68
Roller Φ	12.07

16A-1-2-3 | Platewheels



Z	d _e	d _p	S	D	T
			D ₁	D ₂	D ₃
8	77.0	66.37	12	16	16
9	85.0	74.27	12	16	16
10	93.0	82.19	12	16	16
11	101.5	90.14	16	20	20
12	109.0	98.14	16	20	20
13	117.0	106.12	16	20	20
14	125.0	114.15	16	20	20
15	133.0	122.17	16	20	20
16	141.0	130.20	20	20	25
17	149.0	138.22	20	20	25
18	157.0	146.28	20	20	25
19	165.2	154.33	20	20	25
20	173.2	162.38	20	20	25
21	181.2	170.43	20	25	25
22	189.3	178.48	20	25	25
23	197.5	186.53	20	25	25
24	205.5	194.59	20	25	25
25	213.5	202.66	20	25	25
26	221.6	210.72	20	25	30
27	229.6	218.79	20	25	30
28	237.7	226.85	20	25	30
29	245.8	234.92	20	25	30
30	254.0	243.00	20	25	30
31	262.0	251.08	25	25	30
32	270.0	259.13	25	25	30
33	278.5	267.21	25	25	30
34	287.0	275.28	25	25	30
35	296.2	283.36	25	25	30
36	304.6	291.44	25	25	30
37	312.6	299.51	25	25	30
38	320.7	307.59	25	25	30
39	328.8	315.67	25	25	30
40	336.9	323.75	25	25	30
41	345.0	331.81	25	25	30
42	353.0	339.89	25	25	30
43	361.1	347.97	25	25	30
44	369.1	356.05	25	25	30
45	377.1	364.12	25	25	30
46	385.2	372.20	25	25	30
47	393.2	380.28	25	25	30
48	401.3	388.36	25	25	30
49	409.3	396.44	25	25	30
50	417.4	404.52	25	25	30
51	425.5	412.60	30	30	40
52	433.6	420.68	30	30	40
53	441.7	428.76	30	30	40
54	448.3	436.84	30	30	40
55	457.9	444.92	30	30	40
56	466.0	453.01	30	30	40
57	474.0	461.08	30	30	40
58	482.1	469.16	30	30	40
59	490.2	477.24	30	30	40
60	498.3	485.33	30	30	40
62	514.5	501.49	30	30	40
64	530.7	517.65	30	30	40
65	538.8	525.73	30	30	40
66	546.8	533.80	30	30	40
68	562.9	549.98	30	30	40
70	579.2	566.15	30	30	40
72	595.4	582.31	30	30	40
75	619.7	606.56	30	30	40
76	627.0	614.64	30	30	40
78	643.3	630.81	30	30	40
80	660.0	646.97	30	30	40
85	699.9	687.39	30	30	40
90	740.3	727.80	30	30	40
95	781.1	768.22	30	30	40
100	821.1	808.64	30	30	40
110	902.0	889.48	30	30	40
114	934.3	921.81	30	40	40
120	982.8	970.32	30	40	40
125	1023.3	1010.73	30	40	40

PLATEWHEELS 1" X17.02"

For chain Acc. to DIN 8187
ISO/R 606

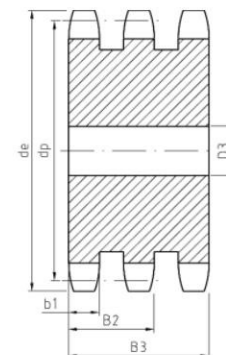
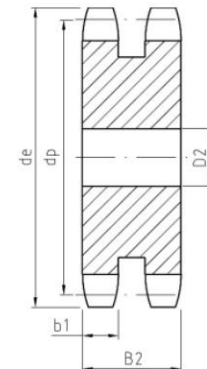
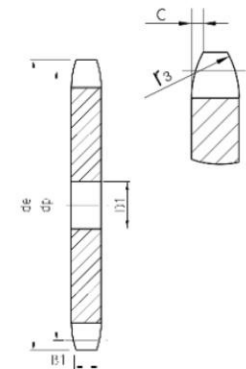

PLATEWHEELS mm

Tooth radius r ₃	26
Radius width C	2.5
Tooth width B ₁	16.2
Tooth width b ₁	15.8
Tooth width B ₂	47.7
Tooth width B ₃	79.6

CHAIN mm

Pitch	25.4
Internal width	17.02
Roller Φ	15.88

20A-1-2-3 | Platewheels



Z	d _e	d _p	S	D	T
			D ₁	D ₂	D ₃
8	98.1	82.96	16	20	20
9	108.0	92.84	16	20	20
10	117.9	102.74	16	20	20
11	127.8	112.68	16	20	20
12	137.8	122.68	20	20	20
13	147.8	132.65	20	20	20
14	157.8	142.68	20	20	20
15	167.9	152.72	20	20	20
16	177.9	162.75	20	25	25
17	187.9	172.78	20	25	25
18	198.0	182.85	20	25	25
19	208.1	192.91	20	25	25
20	218.1	202.98	20	25	25
21	228.2	213.04	25	25	25
22	238.3	223.11	25	25	25
23	248.3	233.17	25	25	25
24	258.4	243.23	25	25	25
25	268.5	253.33	25	25	25
26	278.6	263.40	25	25	25
27	288.6	273.49	25	25	25
28	298.7	283.56	25	25	25
29	308.8	293.65	25	25	25
30	318.9	303.75	25	25	25
31	329.0	313.85	25	25	30
32	339.1	323.91	25	25	30
33	349.2	334.01	25	25	30
34	359.3	344.10	25	25	30
35	369.4	354.20	25	25	30
36	379.5	364.30	25	30	30
37	389.5	374.39	25	30	30
38	399.6	384.49	25	30	30
39	409.7	394.59	25	30	30
40	419.8	404.69	25	30	30
41	429.9	414.77	30	30	30
42	440.0	424.86	30	30	40
43	450.1	434.96	30	30	40
44	460.2	445.06	30	30	40
45	470.3	455.17	30	30	40
46	480.4	465.25	30	30	40
47	490.5	475.35	30	30	40
48	500.6	485.45	30	30	40
49	510.7	495.55	30	30	40
50	520.8	505.65	30	30	40
51	530.9	515.75	30	30	40
52	541.0	525.85	30	30	40
53	551.1	535.95	30	30	40
54	561.2	546.05	30	30	40
55	571.3	556.15	30	30	40
56	581.4	566.25	30	30	40
57	591.5	576.35	30	30	40
58	601.6	586.45	30	30	40
59	611.7	596.56	30	30	40
60	621.8	606.66	30	30	40
62	642.0	626.86	30	30	40
64	662.2	647.07	30	30	40
65	672.3	657.17	30	30	40
66	682.4	667.27	30	30	40
68	702.6	687.48	30	30	40
70	722.8	707.68	30	30	40
72	743.1	727.89	30	30	40
75	773.3	758.20	30	30	40
76	783.5	768.32	30	30	40
80	823.9	808.71	30	30	40
85	874.4	859.23	30	30	40
90	924.9	909.76	30	30	40
95	975.2	960.28	30	30	40
100	1026.0	1010.80	30	30	40
114	1167.4	1152.26	30	40	40

PLATEWHEELS 1" 1/4X3/4"

For chain Acc. to DIN 8187
ISO/R 606

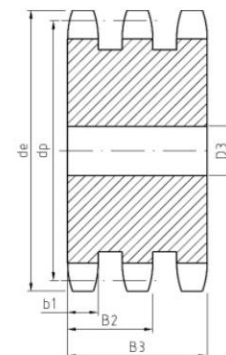
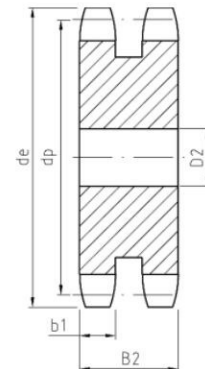
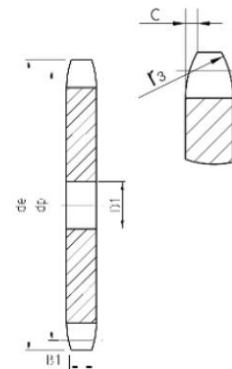

PLATEWHEELS mm

Tooth radius r ₃	32
Radius width C	3.5
Tooth width B ₁	18.5
Tooth width b ₁	18.2
Tooth width B ₂	54.6
Tooth width B ₃	91

CHAIN mm

Pitch	31.75
Internal width	19.56
Roller Φ	19.05

24A-1-2-3 | Platewheels



Z	d _e	d _p	S	D	T
			D ₁	D ₂	D ₃
8	115.0	99.55	20	25	25
9	126.4	111.40	20	25	25
10	138.0	123.29	20	25	25
11	150.0	135.21	20	25	25
12	162.0	147.22	20	25	25
13	174.2	159.18	20	25	25
14	186.2	171.22	20	25	25
15	198.2	183.26	20	25	25
16	210.3	195.30	25	25	25
17	222.3	207.34	25	25	25
18	234.3	219.42	25	25	25
19	246.5	231.49	25	25	25
20	258.6	243.57	25	25	25
21	270.6	255.65	25	25	30
22	282.7	267.73	25	25	30
23	294.8	279.80	25	25	30
24	306.8	291.88	25	25	30
25	319.0	304.00	25	25	30
26	331.0	316.08	30	30	30
27	343.2	328.19	30	30	30
28	355.2	340.27	30	30	30
29	367.3	352.38	30	30	30
30	379.5	364.50	30	30	40
31	391.6	376.62	30	30	40
32	403.7	388.69	30	30	40
33	415.8	400.81	30	30	40
34	427.8	412.93	30	30	40
35	440.0	425.04	30	30	40
36	452.0	437.16	30	30	40
37	464.2	449.27	30	30	40
38	476.2	461.39	30	30	40
39	488.5	473.50	30	30	40
40	500.6	485.62	30	30	40
41	512.6	497.72	30	40	40
42	524.7	509.83	30	40	40
43	536.8	521.95	30	40	40
44	549.0	534.07	30	40	40
45	561.2	546.19	30	40	40
46	573.3	558.30	30	40	40
47	585.4	570.42	30	40	40
48	597.4	582.54	30	40	40
49	609.5	594.66	30	40	40
50	621.7	606.78	30	40	40
51	633.8	618.90	30	40	40
52	646.0	631.01	30	40	40
53	658.0	643.13	30	40	40
54	670.2	655.28	30	40	40
55	682.3	667.40	30	40	40
56	694.4	679.51	30	40	40
57	706.5	691.63	30	40	40
58	718.6	703.74	30	40	40
59	730.7	715.86	30	40	40
60	742.8	727.97	30	40	40
62	767.2	752.24	40	40	40
64	791.3	776.48	40	40	40
65	803.4	788.59	40	40	40
66	815.6	800.71	40	40	40
68	839.8	824.98	40	40	40
70	864.2	849.21	40	40	40
72	888.4	873.48	40	40	40
75	924.8	909.83	40	40	40
76	936.9	921.98	40	40	40
80	985.4	970.44	40	40	40
85	1046.0	1031.10	40	40	40
95	1167.3	1152.33	40	40	40

PLATEWHEELS 1" 1/2X1"

For chain Acc. to DIN 8187
ISO/R 606

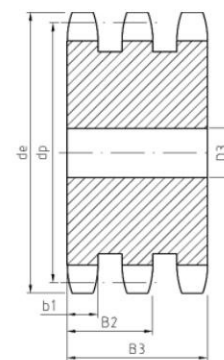
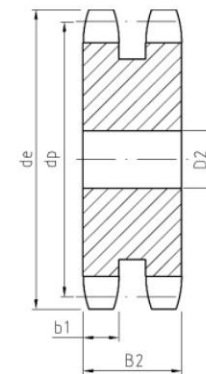
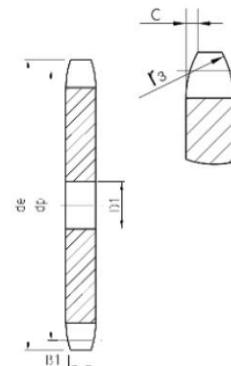

PLATEWHEELS mm

Tooth radius r ₃	38
Radius width C	4
Tooth width B ₁	24.1
Tooth width b ₁	23.6
Tooth width B ₂	72
Tooth width B ₃	120.3

CHAIN mm

Pitch	38.1
Internal width	25.4
Roller Φ	25.4

28A-1-2-3 | Platewheels



Z	d _e	d _p	S	D	T
			D ₁	D ₂	D ₃
8	132.0	116.15	20	25	25
9	148.4	129.96	20	25	25
10	162.3	143.85	20	25	25
11	176.3	157.77	25	25	30
12	189.5	171.74	25	25	30
13	204.2	185.74	25	25	30
14	218.2	199.76	25	25	30
15	232.3	213.79	25	25	30
16	246.3	227.84	30	30	30
17	260.0	241.91	30	30	30
18	274.0	255.98	30	30	30
19	289.0	270.06	30	30	30
20	303.0	284.15	30	30	30
21	317.0	298.24	30	30	30
22	331.0	312.34	30	30	30
23	345.0	326.44	30	30	30
24	359.0	340.55	30	30	30
25	373.0	354.66	30	30	40
26	387.0	368.77	30	30	40
27	401.4	382.88	30	30	40
28	416.0	397.00	30	30	40
29	430.0	411.12	30	30	40
30	444.0	425.24	30	30	40
31	458.0	439.37	30	30	40
32	472.0	453.49	30	30	40
33	486.0	467.62	30	30	40
34	500.0	481.75	30	30	40
35	514.0	495.88	30	30	40
36	529.0	510.01	30	30	40
37	543.0	524.14	30	30	40
38	557.0	538.27	30	30	40
39	571.0	552.40	30	30	40
40	585.0	566.54	30	30	40
45	656.0	637.22	30	30	40
50	726.0	707.91	30	30	40
57	825.0	806.89	40	40	40
60	869.0	849.32	40	40	40
76	1095.0	1075.60	40	40	40

PLATEWHEELS 1" 3/4X1" 1/4

For chain Acc. to DIN 8187
ISO/R 606

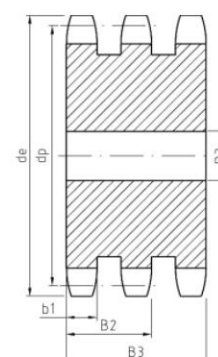
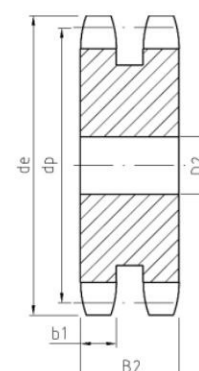
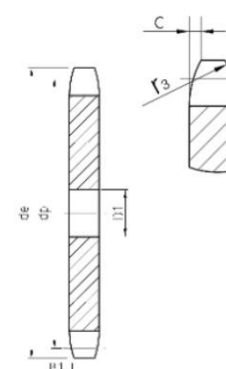

PLATEWHEELS mm

Tooth radius r ₃	44
Radius width C	5
Tooth width B ₁	29.4
Tooth width b ₁	28.8
Tooth width B ₂	88.4
Tooth width B ₃	148

CHAIN mm

Pitch	44.45
Internal width	30.99
Roller Φ	27.94

32A-1-2-3 | Platewheels



Platewheels

Z	d _e	d _p	S	D	T
			D ₁	D ₂	D ₃
8	153.2	132.69	25	25	25
9	169.0	148.54	25	25	25
10	185.0	164.44	25	25	25
11	200.8	180.34	30	30	30
12	216.8	196.29	30	30	30
13	232.8	212.29	30	30	30
14	248.8	228.29	30	30	30
15	264.8	244.30	30	30	30
16	280.9	260.40	30	30	30
17	296.9	276.40	30	30	30
18	313.0	292.55	30	30	30
19	329.1	308.66	30	30	30
20	345.2	324.71	30	30	30
21	361.3	340.82	30	30	40
22	377.5	356.98	30	30	40
23	393.6	373.08	30	30	40
24	409.7	389.18	30	30	40
25	425.8	405.33	30	30	40
26	441.9	421.44	30	30	40
27	458.1	437.59	30	30	40
28	474.2	453.69	30	30	40
29	490.4	469.90	30	30	40
30	506.5	486.00	30	30	40
32	538.8	518.26	30	30	40
35	589.5	566.72	30	30	40
38	635.5	615.14	30	30	40
40	670.3	647.49	40	40	40
45	751.0	728.25	40	40	40
50	831.8	809.04	40	40	40
57	945.0	922.16	40	40	40
60	993.4	970.65	40	40	40
76	1252.0	1229.30	40	40	40

PLATEWHEELS 2" X 1" 1/4

For chain Acc. to DIN 8187
ISO/R 606

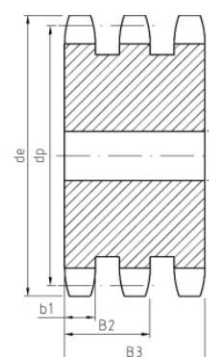
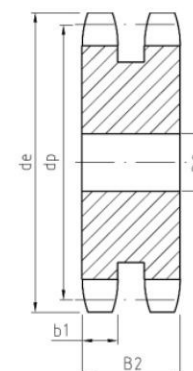
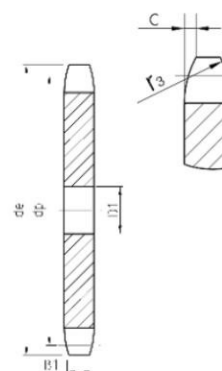

PLATEWHEELS mm

Tooth radius r ₃	51
Radius width C	6
Tooth width B ₁	29.4
Tooth width b ₁	28.8
Tooth width B ₂	87.4
Tooth width B ₃	146

CHAIN mm

Pitch	50.8
Internal width	30.99
Roller Φ	29.21